

Masport[®]
HEATING



NEW!

CLUTHA

ULTRA-LOW EMISSION (ULEB) WOOD FIRE RANGE

The new Masport Clutha ULEB Wood Fire is inspired by and named after New Zealand's second longest river. The Clutha river is famous for its swift-flowing turquoise, ultra-clean water originating from the glaciers. Similarly, the Clutha Wood Fire has a contemporary design suitable for small to medium homes and ultra-clean burning, making it ideal for homes with a wide range of decors throughout New Zealand.



masportheating.co.nz

CLUTHA

ULTRA-LOW EMISSION (ULEB) WOOD FIRE RANGE



The Clutha Wood Fire has a portrait orientation, a compact footprint, and an expansive viewing window to see the fire inside. The Clutha is fitted with Ceramic Fire Bricks and Stainless Steel Boxed Baffle; both provide best-in-class performance and durability, ensuring unrivaled performance and low maintenance, which lowers running costs over the life of the fire.

- ▶ Ultra-clean burning that is better for air quality
- ▶ Contemporary design suitable for a wide range of décors
- ▶ Large portrait window with an expansive flame view
- ▶ Three base options to suit your needs and taste
 - Concealed, easy clean Ash Pan base*
 - Convenient wood storage solution with Wood Stacker base*
 - Pedestal only base
- ▶ Small footprint ideal for small spaces
- ▶ Ceramic Fire Bricks for greater heat retention and durability
- ▶ Stainless Steel Boxed Baffle for superior performance and longevity
- ▶ Lower long-term running costs due to quality components
- ▶ Start-Up Latch mechanism for ease of operation and safety
- ▶ 15 years firebox warranty**
- ▶ Does not require electricity
- ▶ Made in New Zealand
- ▶ Future proof solution for all regions of New Zealand



Finish	Metallic Black VHT
Space Heat Output***	Suitable for small to medium homes 2-3 bedrooms
Dimensions w x d x h	495 x 524 x 894mm

BASE OPTIONS	PEDESTAL	ASH PAN	WOOD STACKER
Fire Only	999916	999921	999922
Flue Only	GDFLU013M	GDFLU013M	GDFLU013M
Fire & Flue Pack	CLUTHAPEDPACK	CLUTHAASHPACK	CLUTHAWSPACK



Future proof your purchase, as New Zealand continues to refine regulations to protect our natural environment, a ULEB wood fire complies to the most stringent rules in place.

Clearance Specifications

Minimum distance to heat sensitive materials (mm) - when a Masport Double Skin Flue Shield is fitted as per Masport specifications.

Model	Type of Flue Shield	Type of Floor Protector	A	B	C	D	E	F	G	H	I	J	K	L	M	N	R	W
Clutha PED / ASH / WS	MDSM	AFP	83	325	300	117	144	246	573	384	428	729	902	1199	998	656	543	495

Flue Shield

MDSM Masport Double Skin Flue Shield 900mm long (Ceiling Plate included with Flue Kit)

Floor Protector

AFP Ash Floor Protector

Masport Steel Floor Protectors
Parallel - 998901 & 998908
Corner - 998904 or 998909

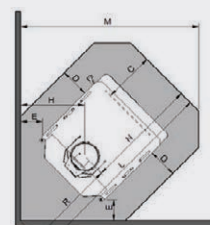
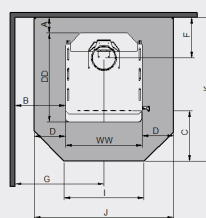

*ASH and WOOD STACKER options will be available from April 2023.

**Refer to the owner manual for detailed terms and conditions of the product warranty.

***Space Heat Output is only a guide based on homes with average insulation, window area, and 2.4m ceiling heights. Differences in these factors, as well as others like, geographical location, layout of the house, living room size, type of windows all play a part in choosing the right model for your heating needs. Consult your dealer or installation contractor for more information.



Glen Dimplex New Zealand Ltd PO Box 58473, Botany, Auckland

Glen Dimplex New Zealand Ltd's policy is one of continuous development. We reserve the right to change size and specifications without notice. For confirmation of Masport Heating product details please refer to www.masportheating.co.nz. Please refer to the installation and operation instructions before having your Masport Wood Fire installed. A full set of these instructions is supplied with each fire.