

nectre®

Nectre N65



Contemporary Design

Great Performance

The **Nectre N65** is beautifully compact, yet powerful enough to **heat 150m² of living area.**

The sleek design fits beautifully in either a **traditional or contemporary living area.** With its tested high efficiency and low emission rating, the Nectre N65 is a welcome addition to your living space.



Nectre N65



Curved side model

Nectre	A	B	C	D	E	F	G	H	I	J	K	L
N65	125	350	296	640	933	900	150	480	750	600	1150	680

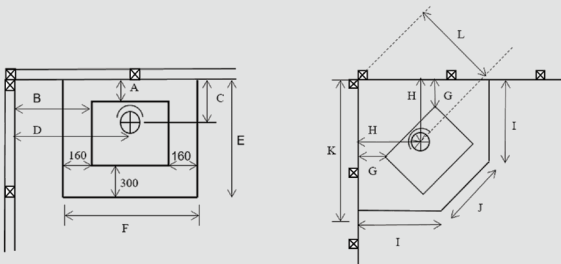

Clearances to
combustible
surrounds

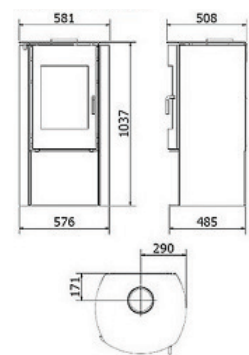

Specifications

Additional Features

76%
EFFICIENCY

0.90g
EMISSIONS

15kW
ESTIMATED PEAK
HEAT OUTPUT

420mm
MAX LOG

150sqm
COVERAGE

6.0mm
CONSTRUCTION

- Finished in black metallic paint
- Steel door with ceramic glass
- Stainless steel handle
- Steel baffle with steel brick retainer
- Vermiculite/firebrick lining to improve thermal mass

- 2 x 6.0mm steel baffle plate
- 6.0mm steel firebox with 8mm radiant top
- Steel firebrick retainer
- Concealed ash-pan
- Approved lower wood storage
- Door aperture is 305 x 380
- Firebox size 345(w) x 275(d) x 450(h)
- Firebox cubic size is 0.043m³
- Weight is 190kg
- Flue spigot size is 150mm

Safety, emissions and efficiency testing is accordance with AS/NZS 4013, AS/NZS 4012 and AS/NZS 2918:2001. Emissions quoted are grams per kilogram. Construction of the Nectre N65 is mild steel. Efficiency percentages quoted are peak. Burn time quoted is up to. Kilowatt output quoted is peak.

*Burn times may vary, to achieve best burn rate times please visit www.nectre.com

Phone: 09 274 0658

www.broadys.co.nz